

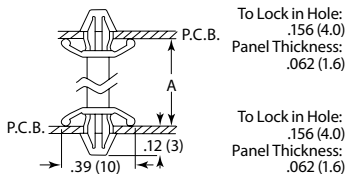

LOCKING CIRCUIT BOARD SUPPORTS

CBDLS Series Double Locking Support



Specifications:

- Material: Nylon 6/6
- Color: Natural
- Flame Class: UL94 V-2

Item No.	A		Bulk Pack Qty.
	In	mm	
CBDLS105A	0.236	6.0	1000
CBDLS110A	0.315	8.0	1000
CBDLS115A	0.394	10.0	1000
CBDLS120A	0.472	12.0	1000
CBDLS125A	0.512	13.0	1000

Item No.	A		Bulk Pack Qty.
	In	mm	
CBDLS130A	0.551	14.0	1000
CBDLS135A	0.630	16.0	1000
CBDLS140A	0.661	16.8	1000
CBDLS145A	0.709	18.0	1000
CBDLS150A	0.787	20.0	1000

SP1 Support Post

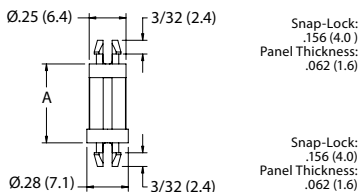

Specifications:

- Material: Nylon 6/6
- Color: Natural
- Flame Class: UL94 V-2

Item No.	A		Bulk Pack Qty.
	In	mm	
SP1-3-01	0.188	4.8	1000
SP1-4-01	0.250	6.4	1000
SP1-6-01	0.375	9.5	1000
SP1-8-01	0.500	12.7	1000

Item No.	A		Bulk Pack Qty.
	In	mm	
SP1-10-01	0.625	15.9	1000
SP1-12-01	0.750	19.1	1000
SP1-14-01	0.875	22.2	1000
SP1-16-01	1.000	25.4	1000

CBLSP/DLSP-1 Locking Support Posts

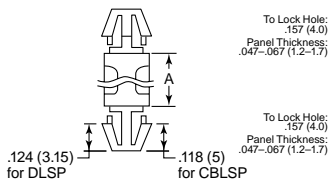

Features:

- Material: Nylon 6/6
- Color: Natural
- Flame Class: UL94 V-2
- Dual end locking feature will keep both panels secure once in place
- Eliminates screws, nuts and lock washers from mounting

Item No.	A		Bulk Pack Qty.
	In	mm	
DLSP-1-3M-01	0.118	3.0	1000
CBLSP010A	0.138	3.5	2000
DLSP-1-4M-01	0.157	4.0	1000
CBLSP020A	0.197	5.0	2000
DLSP-1-6M-01	0.236	6.0	1000
CBLSP030A	0.250	6.4	1000
DLSP-1-8M-01	0.315	8.0	1000
DLSP-1-10M-01	0.394	10.0	1000
CBLSP045A	0.413	10.5	1000
CBLSP050A	0.453	11.5	1000
DLSP-1-12M-01	0.472	12.0	1000
CBLSP060A	0.500	12.7	1000
DLSP-1-14M-01	0.551	14.0	1000
DLSP-1-16M-01	0.625	15.9	1000

Item No.	A		Bulk Pack Qty.
	In	mm	
DLSP-1-18M-01	0.709	18.0	1000
CBLSP080A	0.748	19.0	1000
CBLSP085A	0.787	20.0	1000
CBLSP090A	0.984	25.0	1000
CBLSP095A	1.063	27.0	1000
CBLSP100A	1.181	30.0	1000
CBLSP105A	1.339	34.0	1000
CBLSP110A	2.717	69.0	500
CBLSP115A	2.803	71.2	500
CBLSP120A	2.835	72.0	500
CBLSP125A	2.921	74.2	500
CBLSP130A	3.150	80.0	500
DLSP-1-25M-01	0.984	25.0	1000
DLSP-1-30M-01	1.181	30.0	1000

MSPS Mini Support Post

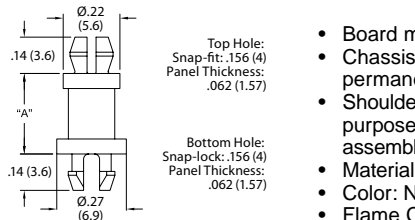
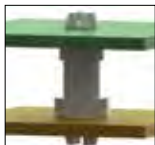

- Board mount head is releasable
- Chassis mount head locks permanently
- Shoulder added for locating purposes to facilitate automated assembly
- Material: Nylon 6/6
- Color: Natural
- Flame Class: UL94 V-2

Item No.	A		Bulk Pack Qty.
	In	mm	
MSPS-3-01	3/16 (4.8)		1000
MSPS-4-01	1/4 (6.4)		1000
MSPS-5-01	5/16 (7.9)		1000
MSPS-6-01	3/8 (9.5)		1000
MSPS-7-01	7/16 (11.1)		1000
MSPS-8-01	1/2 (12.7)		1000
MSPS-10-01	5/8 (15.9)		1000
MSPS-11-01	11/16 (17.5)		1000
MSPS-12-01	3/4 (19.1)		1000
MSPS-14-01	7/8 (22.2)		1000

DLCBS7 Dual Locking Circuit Board Support

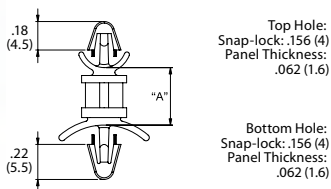

- Both ends lock by hand, no tools required
- "Wings" provide a tight fit to the boards and allow for various panel thicknesses
- Material: UL94 V-2, Nylon 6/6
- Color: Natural
- Flame Class: UL94 V-2

Item No.	A		Bulk Pack Qty.
	In	mm	
DLCBS7-3-01	3/16 (4.8)		1000
DLCBS7-4-01	1/4 (6.4)		1000
DLCBS7-5-01	5/16 (7.9)		1000
DLCBS7-6-01	3/8 (9.5)		1000
DLCBS7-7-01	7/16 (11.1)		1000

Item No.	A		Bulk Pack Qty.
	In	mm	
DLCBS7-8-01	1/2 (12.7)		1000
DLCBS7-9-01	9/16 (14.3)		1000
DLCBS7-10-01	5/8 (15.9)		1000
DLCBS7-12-01	3/4 (19.1)		1000

BHDL Blind Hole Dual Locking Circuit Board Support

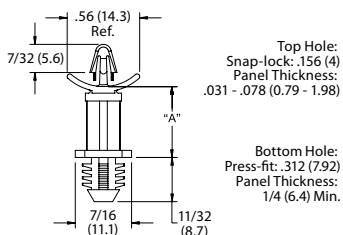

- Fir-tree mount is flexible and will lock into round, threaded, punched or drilled blind holes
- Material: Nylon 6/6
- Color: Natural
- Flame Class: UL94 V-2

Item No.	A		Bulk Pack Qty.
	In	mm	
BHDL-4-01	1/4 (6.4)		1000
BHDL-6-01	3/8 (9.5)		1000
BHDL-8-01	1/2 (12.7)		1000

Item No.	A		Bulk Pack Qty.
	In	mm	
BHDL-10-01	5/8 (15.9)		1000
BHDL-12-01	3/4 (19.1)		1000
BHDL-14-01	7/8 (22.2)		1000